

Bandschleifer
Belt grinder
Ponceuse à ruban

LBB 20

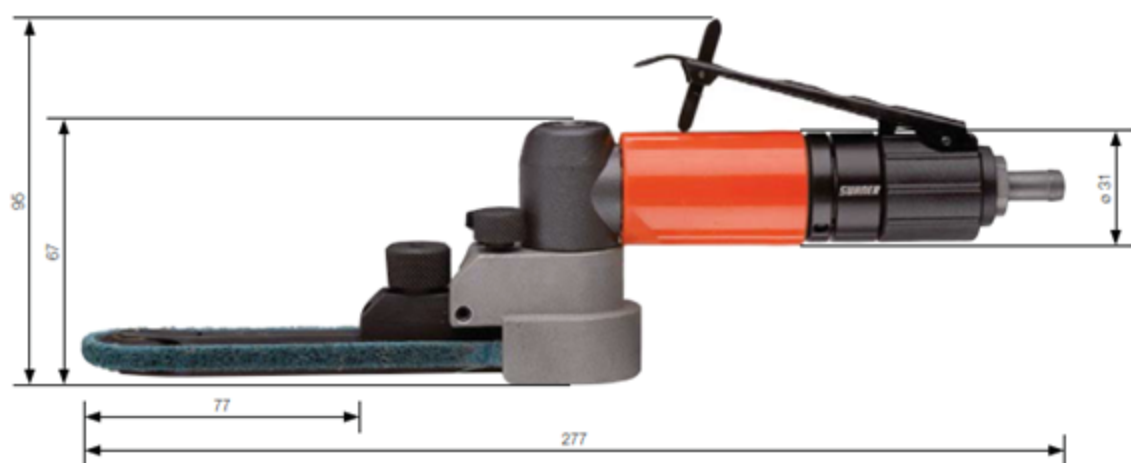
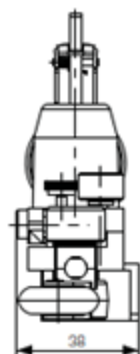

Mini-Bandschleifset / Belt grinder set / Ponceuse à ruban set

LBB 20 Set

Best.-Nr./Order No./No. de cde.

112 219 00



Belt grinder LBB 20 with belt grinding attachment, with contact arm 25/9, matching 4 belts of each K80/120 and 4 non-woven fibre belts of each M and VF. /

- 5 different contact arms, easy changing and easy adjustment of the belts
- Small, handy, powerful

Applications

Powerful, lightweight belt grinder. For cleaning and removing burrs, defining a radius, blending surface finishes, centerless polishing, denibbing, scuffing, generating decorative satin finishes on metal.